

7/8" Mini-Receptacle Connectors, Front Mount, IEC Color Code

RSF 20...50 | RKF 20...50



Male, 2-, 3-, 4-, and 5-Pole

Receptacle connector, 7/8"-A body, male 2-, 3-, 4-, and 5-pole for front mounting, assembled stranded wire, potted with epoxy, chassis side thread 1/2" NPT, screw connection.

- IEC Color Code -

RSF 20...50

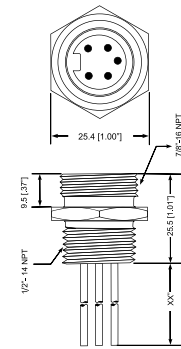

Female, 2-, 3-, 4-, and 5-Pole

Receptacle connector, 7/8"-A body, female 2-, 3-, 4-, and 5-pole for front mounting, assembled stranded wire, potted with epoxy, chassis side thread 1/2" NPT, screw connection.

- IEC Color Code -

RKF 20...50

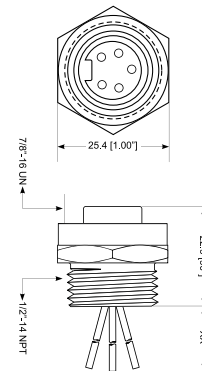

Pin Assignments

Face Views, 7/8"-Male / Female

2 pole

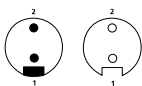

1 = brown
2 = blue

3 pole

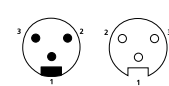

1 = black
2 = brown
3 = blue

4 pole

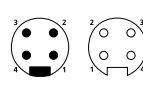

1 = black
2 = blue
3 = brown
4 = white

5 pole

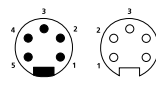

1 = black
2 = blue
3 = yellow/green tr.
4 = brown
5 = white



Be Certain with Belden

7/8" Mini-Receptacle Connectors, Front Mount, IEC Color Code
 RSF 20...50 | RKF 20...50

Technical Data

Environmental

Degree of protection IP 68 / NEMA 6P
 Operating temperature range -40°C (-40°F) / +90°C (+194°F)

Mechanical

Molded body TPU, yellow
 Contacts CuZn, gold plated
 Receptacle shell RSF: Zinc die cast (e-coated black)
 RKF: Aluminum (clear anodized)
 Locknut Steel, zinc plated
 O-ring Viton

Electrical

Current rating 2 pole: 12 A
 3 pole: 8 A
 4 and 5 pole: 5.6 A
 Voltage Rating 300 V

Part Number	Pins	Gauge	Characteristics
RSF 20-603/0.3 M RKF 20-603/0.3 M	2	18	
RSF 30-695/0.3 M RKF 30-695/0.3 M	3	18	
RSF 40-693/0.3 M RKF 40-693/0.3 M	4	18	
RSF 50-694/0.3 M RKF 50-694/0.3 M	5	18	

Receptacles