

## 7/8" Mini-Receptacle Connectors, Front Mount, Automotive Color Code

RSF 30...50 | RKF 301...501



### Male, 3- and 5-Pole

Receptacle connector, 7/8"-A body, male 3- and 5-pole for front mounting, assembled stranded wire, potted with epoxy, chassis side thread 1/2" NPT, screw connection.

- Automotive Color Code -

RSF 30...50

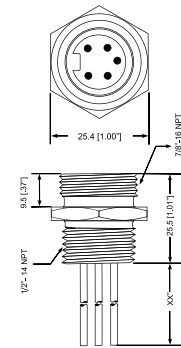

### Female, 3- and 5-Pole

Receptacle connector, 7/8"-A body, female 3- and 5-pole for front mounting, assembled stranded wire, potted with epoxy, chassis side thread 1/2" NPT, screw connection.

- Automotive Color Code -

RKF 301...501

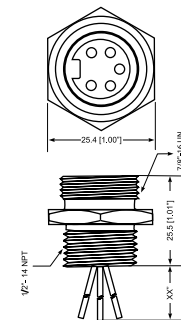

## Pin Assignments

Face Views, 7/8"-Male / Female

### 3 pole

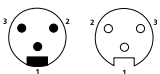

1 = green  
2 = red/black  
3 = red/white

### 5 pole

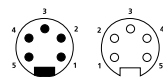

1 = red/white  
2 = red  
3 = green  
4 = red/yellow  
5 = red/black



Be Certain with Belden

**7/8" Mini-Receptacle Connectors, Front Mount, Automotive Color Code**  
 RSF 30...50 | RKF 301...501

**Technical Data**

**Environmental**

Degree of protection IP 68 / NEMA 6P  
 Operating temperature range -40°C (-40°F) / +90°C (+194°F)

**Mechanical**

Insert TPU, yellow  
 Contacts CuZn, gold plated  
 Receptacle shell Zinc die cast (e-coated black)  
 Locknut Steel, zinc plated  
 O-ring Viton

**Electrical**

**641 and 642**  
 Current rating 8 A  
 Voltage rating 600 V

**690**  
 Current rating 5.6 A  
 Voltage rating 300 V

Part Number	Pins	Gauge	Characteristics
RSF 30-641/1F    RKF 301-641/1F	3	16	
RSF 50-642/1F    RKF 501-642/1F	5	16	
RSF 50-690/1F    RKF 501-690/1F	5	18	

Receptacles