



GDM Series Rectangular Receptacle Connectors, Type A

Technical Information

Product Description		
Order Designation	GSE 2000 N4	GSE 3000 N4
		
Description	Male appliance connector for installation in sheet metal, rotating round collar, retaining nut and 4 screws M3 x 6	Male appliance connector for installation in sheet metal, rotating round collar, retaining nut and 4 screws M3 x 6
RoHS-Compliant (2011/65/EU)	Yes	
(Construction Type) Standard	DIN EN 175 301-803-A	
Approvals	VDE, SEV	
Technical Data		
No. of Pins	2 + PE	3 + PE
Ambient Temperature	-40 °C to +125 °C	
Housing/Grip/Screw Coupling	PA	
Contact Holder	PA	
Contact	SN	
Mechanical Data		
Degree of Protection	IP65 (gasket required, only when plugged in, only when mated with Hirschmann/Lumberg counterparts)	
Terminal Type	Solder	
Electrical Data		
Circuit	No protection circuit	
Contact Resistance	≤ 4 mΩ	
Rated Voltage	400 V AC/DC	
Rated Current	16 A	
Pollution Degree	3	
Accessories		
Scope of Delivery or Accessories (incl.)	Items supplied in one package: 200	
Accessories to be Ordered Separately	(NBR) flat gasket GSE 2000-2, Order No. 733973002 (EPDM) flat gasket GSA 200-7, Order No. 730268003	

Technical Drawing

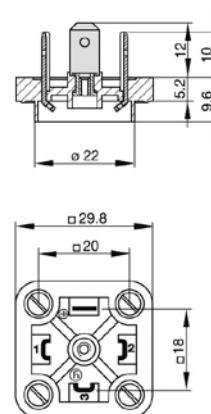
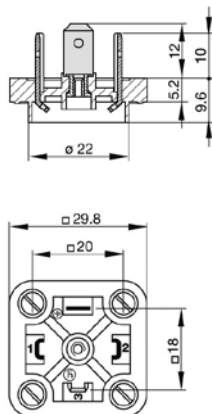

Be Certain with Belden

Order Information

Order No.	Order Designation	No. of Pins	Terminal Type
932886100	GSE 2000 N4 black	2 + PE	solder
932890100	GSE 3000 N4 black	3 + PE	solder