



GDM Series Valve Connectors, Type A, Field Attachable Female Connectors, Protection Circuit: RC Filter and LED

Technical Information

Product Description	
Order Designation	GDM21FX-C2Y



Description	Valve connector GDM series, type A, female connector, field attachable
RoHS-Compliant (2011/65/EU)	Yes
(Construction Type) Standard	DIN EN 175301-803-A
Approvals	VDE, SEV
Connectible Cables	Ø 4.5 to 10 mm
Conductor Size	0.25 x 1.5 mm ²

Technical Data	
No. of Pins	2 + PE
Ambient Temperature	-25 °C to +90 °C
Housing/Grip/Screw Coupling	PA
Contact Holder	PA
Contact	CuZn
Central Screw	4.8, Fe/Zn B
O-Ring Material	SBR/NBR
Flammability Class	HB

Mechanical Data	
Degree of Protection	IP65 (only when mated with Hirschmann/Lumberg counterparts)
Terminal Type	Screw

Electrical Data	
Circuit	RC filter
Contact Resistance	≤ 4 mΩ
Rated Voltage	24 V AC/DC, 48 V AC/DC, 230 V AC/DC
Rated Current	10 A
Pollution Degree	3

Accessories	
Scope of Delivery or Accessories (incl.)	Central screw

Accessories to be Ordered Separately	<p>Gasket:</p> <p>735-677-003, NBR, Temp. range: -25 °C to +90 °C, captive gasket GDMF-6 NBR, black 735-677-004, EPDM, Temp. range: -25 °C to +120 °C, captive gasket GDMF-6 EPDM, brown 730-801-002, NBR, Temp. range: -30 °C to +90 °C, flat gasket GDM 3-7, brown 731-739-004, EPDM, Temp. range: -40 °C to +125 °C, flat gasket GDM 3-21, brown 731-531-002, NBR, Temp. range: -30 °C to +90 °C, profiled gasket GDM 3-16, black 735-823-002, EPDM Temp. range: -40 °C to +125 °C, profiled gasket GDM 3-24, brown</p> <p>Central screw:</p> <p>732488002, knurled screw (gray), GDM 3011-7 734363001, stainless steel screw, GDM 3011 RF-1 735507002, torx screw, GDM 3011-18</p>
--------------------------------------	---

Technical Drawing

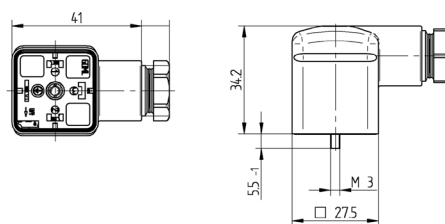



Be Certain with Belden

Circuit Diagram

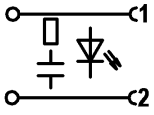
P-Code: C2



Order Information

Order Designation	No. of Pins	Circuit	Cable Gland	Rated Voltage	Rated Current	Characteristics
GDM21F6-C2Y	2 + PE	yellow LED, RC filter	M16 x 1.5	230 V AC/DC	10 A	  
GDM21FA-C2Y	2 + PE	yellow LED, RC filter	M20 x 1.5	230 V AC/DC	10 A	